

Chinook High School

Entry and Exit Map & Guidelines

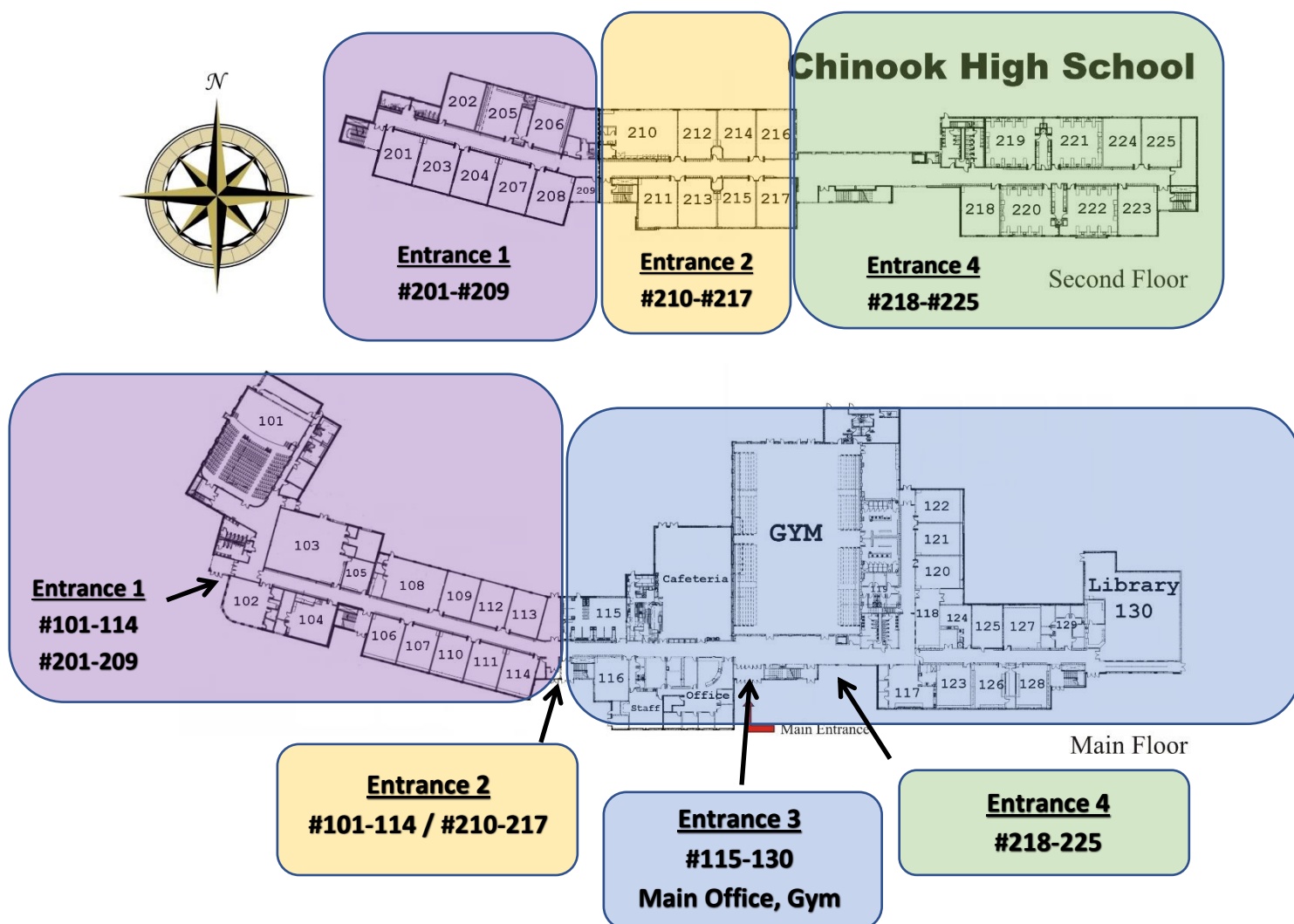

Where to Enter Chinook High School: According to Classroom Number

Classrooms #101-114: Enter through Entrance 1 or Entrance 2

Classrooms #115-130, Main Office, Gym: Enter through Entrance 3

Classrooms #201-209: Enter through Entrance 1

Classrooms #210-217: Enter through Entrance 2

Classrooms #218-225: Enter through Entrance 4

DOORS OPEN AT 7:45 AM, DOORS LOCK AT 8:10 AM